



Comhairle Contae Chill Mhantáin Wicklow County Council

**Pleanáil, Forbairt Eacnamaíochta agus Tuaithe
Planning, Economic and Rural Development**

Áras An Chontae / County Buildings
Cill Mhantáin / Wicklow
Guthán / Tel (0404) 20148
Facs / Fax (0404) 69462
Rphost / Email plandev@wicklowcoco.ie
Suíomh / Website www.wicklow.ie

**Alphaplan Design
Suite 14, Block 1
Broomhall Business Park
Rathnew
Co. Wicklow**

11 July 2025

RE: Declaration in accordance with Section 5 of the Planning & Development Acts 2000 (As Amended) – EX63/2025 –

I enclose herewith Declaration in accordance with Article 5 (2) (A) of the Planning & Development Act 2000.

Where a Declaration is used under this Section any person issued with a Declaration under subsection (2) (a) may, on payment to An Bord Pleanála of such fee as may be prescribed, refer a declaration for review by the Board within four weeks of the date of the issuing of the declaration by the Local Authority.

Is mise, le meas,

**ADMINISTRATIVE OFFICER
PLANNING, ECONOMIC & RURAL DEVELOPMENT**

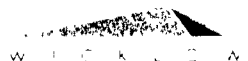



Comhairle Contae Chill Mhantáin Wicklow County Council

**Pleanáil, Forbairt Eacnamaíochta agus Tuaithe
Planning, Economic and Rural Development**

Áras An Chontae / County Buildings
Cill Mhantáin / Wicklow
Guthán / Tel (0404) 20148
Faics / Fax (0404) 69462
Rphost / Email plandev@wicklowcoco.ie
Suíomh / Website www.wicklow.ie

DECLARATION IN ACCORDANCE WITH ARTICLE 5 (2) (A) OF THE PLANNING & DEVELOPMENT ACT 2000 AS AMENDED

Applicant: Linda McGarry

Location: Ballycullen, Co. Wicklow

Reference Number: EX 63/2025

CHIEF EXECUTIVE ORDER NO. CE/PERD/2025/713

A question has arisen as to whether "The felling of 2 parcels of 0.4ha each of forestry" at Ballycullen, Co. Wicklow is or is not exempted development.

Having regard to:

- a) Section 5 application lodged, and the details submitted on the 23rd June 2025.
- b) Section 2,3 , 4 of the Planning and Development Act 2000(as amended)

Main Reasons with respect to Section 5 Declaration:

1. The felling of 2 parcels of 0.4ha each of trees would be exempted development having regard to the provisions Section 4 (1)(i) which provides that development consisting of the thinning, felling or replanting of trees, forests or woodlands or works ancillary to that development, but not including the replacement of broadleaf high forest by conifer species would be exempt development .

The Planning Authority considers that "The felling of 2 parcels of 0.4ha each of forestry" at Ballycullen, Co. Wicklow is development and is exempted development

Signed:

ADMINISTRATIVE OFFICER

PLANNING, ECONOMIC & RURAL DEVELOPMENT

Dated 11th July 2025

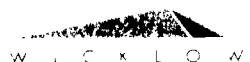

WICKLOW COUNTY COUNCIL
PLANNING & DEVELOPMENT ACTS 2000 (As Amended)

SECTION 5

CHIEF EXECUTIVE ORDER NO. CE/PERD/2025/713

Reference Number: EX 63/2025

Name of Applicant: Linda McGarry

Nature of Application: Section 5 Referral as to whether or not "The felling of 2 parcels of 0.4ha each of forestry" is or is not development and is or is not exempted development.

Location of Subject Site: Ballycullen, Co. Wicklow

Report from Edel Bermingham, SEP

With respect to the query under section 5 of the Planning & Development Act 2000 as to whether "The felling of 2 parcels of 0.4ha each of forestry" at Ballycullen, Co. Wicklow is or is not exempted development within the meaning of the Planning & Development Acts 2000 (as amended).

Having regard to:

- (a) Section 5 application lodged, and the details submitted on the 23rd June 2025.
- (b) Section 2,3 , 4 of the Planning and Development Act 2000(as amended)

Main Reason with respect to Section 5 Declaration:

- i. The felling of 2 parcels of 0.4ha each of trees would be exempted development having regard to the provisions Section 4 (1)(i) which provides that development consisting of the thinning, felling or replanting of trees, forests or woodlands or works ancillary to that development, but not including the replacement of broadleaf high forest by conifer species would be exempt development .

Recommendation

The Planning Authority considers that "The felling of 2 parcels of 0.4ha each of forestry" at Ballycullen, Co. Wicklow is development and is exempted development as recommended in the report by the SEP.

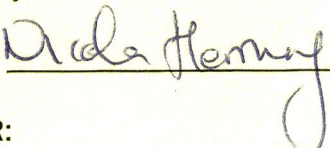
Signed 

Dated 9th day of July 2025

ORDER:

I HEREBY DECLARE:

That "The felling of 2 parcels of 0.4ha each of forestry" at Ballycullen, Co. Wicklow is development and is exempted development within the meaning of the Planning & Development Act 2000 (as amended).

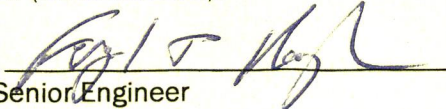
Signed: 
Senior Engineer
Planning, Economic & Rural Development

Dated 12th day of July 2025

Section 5 Application : EX 63/2025

Date : 4/7/2025

See previous Section 5 report dated the 17th June 2025, further information request issued and a reply was received on the 23rd June 2025.

Assessment of FI submission :

Item 1

1. In order to fully assess the Section 5 query, you are requested to submit further details concerning the proposed development, as follows:

- a) Please confirm the query for which a Section 5 declaration is sought. In this regard, please:
- confirm number and size of forestry plots to which the query relates;
 - provide details of the nature of the works proposed. Note: the felling licence application form indicates that it is proposed to clear fell 2no. plots and change the use of the lands (deforestation);
- b) Please confirm whether the development is licensed or approved under section 6 of the Forestry Act 2014 (No. 31 of 2014). If a licence has been granted, a copy of same should be submitted.

Submission

Map submitted showing plots to be clearfelled - 2 plots both 0.40h. No comment received with respect to any future change of use. Indicated required for felling license application.

Assessment :

It is considered that the details show areas to be clear felled, and the need for same. The query re change of use is noted however as this is not part of the Section 5 Declaration and therefore no further assessment of that element is required.

Section 4 (1)(i) provides the following shall be exempted i.e.

(i) development consisting of the thinning, felling or replanting of trees, forests or woodlands or works ancillary to that development, but not including the replacement of broadleaf high forest by conifer species;

Therefore, the works would come within the provisions of Section 4(1)(i) of the Planning and Development Act 2000(as amended).

Note the scale of the proposal would not give rise to the need for EIA. In addition the forestry is not located on or adjoining any Natura 2000 site, and there is no hydrological connection to any Natura 2000 site and therefore the development would not give rise on its own or in combination

to any impacts on any Natura 2000 site, and the need for a Stage 2 Appropriate Assessment can be screened out.

Recommendation :

With respect to the query under Section 5 of the Planning and Development Act 2000(as amended), as to whether

The felling of 2 parcels of 0.4ha each of forestry at Ballycullen, Co. Wicklow

constitutes exempted development within the meaning of the Planning and Development Acts, 2000(as amended).

The Planning Authority consider that :

The felling of 2 parcels of 0.4ha each of forestry at Ballycullen, Co. Wicklow
is Development and is Exempted Development

Main Considerations with respect to Section 5 Declaration :

- (a) Section 5 application lodged, and the details submitted on the 23rd June 2025.
- (b) Section 2,3 , 4 of the Planning and Development Act 2000(as amended)

Main Reasons with respect to Section 5 Declaration :

- i. The felling of 2 parcels of 0.4ha each of trees would be exempted development having regard to the provisions Section 4 (1)(i) which provides that development consisting of the thinning, felling or replanting of trees, forests or woodlands or works ancillary to that development, but not including the replacement of broadleaf high forest by conifer species would be exempt development .

B. L. Cunningham

4/7/2025

*Issue declaration is recommended
for 1st July 25
14/7/25*



Comhairle Contae Chill Mhantáin Wicklow County Council

Pleanáil, Forbairt Eacnamaíochta agus Tuaithe
Planning, Economic and Rural Development

MEMORANDUM

Áras An Chontae / County Buildings
Cill Mhantáin / Wicklow
Guthán / Tel: (0404) 20148
Faics / Fax: (0404) 69462
Rphost / Email: plandev@wicklowcoco.ie
Suíomh / Website: www.wicklow.ie

WICKLOW COUNTY COUNCIL

TO: Suzanne White
Senior Executive Planner

FROM: Nicola Fleming
Staff Officer

**RE:- Application for Certificate of Exemption under Section 5 of the
Planning and Development Acts 2000 (as amended).
EX63/2025**

I enclose herewith application for Section 5 Declaration received completed on 26/05/2025 along with FI received on 23/06/2025.

The due date on this declaration is 13th July 2025.

Staff Officer
Planning, Economic & Rural Development





Comhairle Contae Chill Mhantáin Wicklow County Council

**Pleanáil, Forbairt Eacnamaíochta agus Tuaithe
Planning, Economic and Rural Development**

Áras An Chontae / County Buildings
Cill Mhantáin / Wicklow
Guthán / Tel (0404) 20148
Faics / Fax (0404) 69462
Rphost / Email plandev@wicklowcoco.ie
Suíomh / Website www.wicklow.ie

**Alphaplan Design
Suite14 , Block 1
Broomhall Business Park
Rathnew
Co. Wicklow**

24th June 2025

RE: Application for Certificate of Exemption under Section 5 of the Planning and Development Acts 2000 (as amended). – EX63/2025 for Linda McGarry

A Chara

I wish to acknowledge receipt on 26/05/2025 full details supplied by you in respect of the above Section 5 application along with Further Information received on 23/06/2025. A decision is due in respect of this application by 13/07/2025.

Mise, le meas



**Nicola Fleming
Staff Officer
Planning, Economic & Rural Development**



ALPHAPLAN DESIGN

HOME DESIGN AND PLANNING SERVICES

Suite 14, Block 1, Broomhall Business Park, Rathnew, Co. Wicklow A67 C634

Tel: (0404) 64123 (086) 2461269

E Mail: eugene@alphaplandesign.com

Website: www.alphaplandesign.com

Company Reg. No. 158820. Reg. Vat. No. IE3212037H

FURTHER INFORMATION

RE: Section 5 Application - EX63/2025

RECEIVED 22 JUN 2025

Applicant: Linda mcGarry

Dear Sir / Madam,

Further to your request for additional information dated 18th June 2025 enclosed please find the following:

1. There are two x 0.40 hectare plots in this application as indicated on the enclosed OS map numbers 1 and 2.
2. It is proposed that both plots will be deforested.
3. This application is being made on instructions of the Dept of Agriculture, Food and the Marine who have requested that a Section 5 decision should issue as part of the felling licence application process.

I trust this is in order..

Thanking you,

Yours sincerely,

EUGENE COPELAND

23rd June 2025

RECEIVED 23 JUN 2025

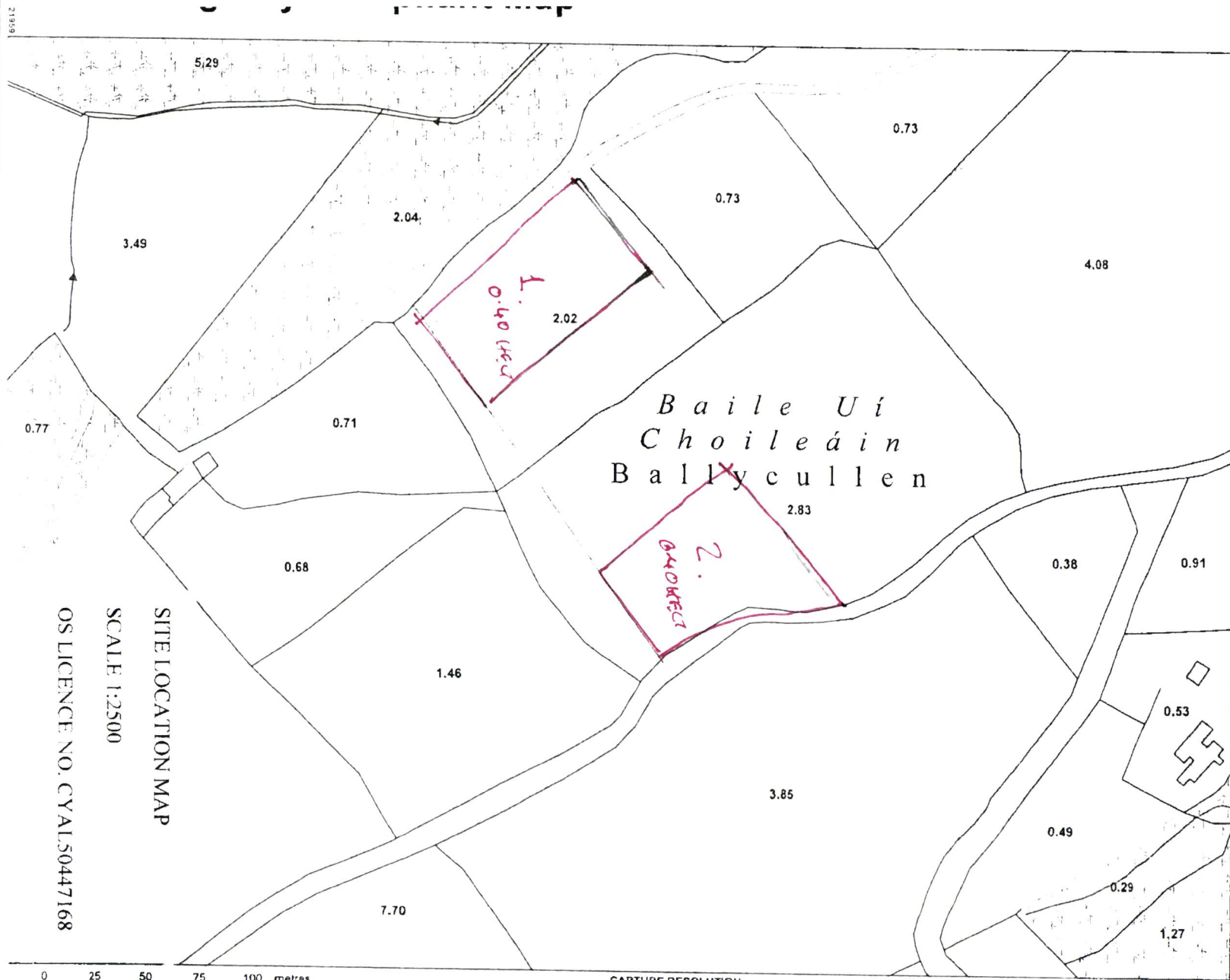

CENTRE COORDINATES:
ITM 722251,696592

PUBLISHED: 16/11/2021
ORDER NO.: 50233481_1

MAP SERIES: 1:5,000
MAP SHEETS: 3961

COMPILED AND PUBLISHED BY:
Ordnance Survey Ireland,
Phoenix Park,
Dublin 8,
Ireland.

Unauthorised reproduction
infringes Ordnance Survey Ireland
and Government of Ireland
copyright.

All rights reserved.
No part of this publication may
be copied, reproduced
or transmitted in any form
or by any means without the prior
written permission of
the copyright owners.

The representation on this map
of a road, track or footpath
is not evidence of the existence
of a right of way.

Ordnance Survey maps
never show legal property
boundaries, nor do they
show ownership of
physical features.

© Suirbhéireacht Ordnáis Éireann,
2021
© Ordnance Survey Ireland, 2021
www.osi.ie/copyright

LEGEND:
<http://www.osi.ie>,
search 'Large Scale Legend'

SITE LOCATION MAP
SCALE 1:2500
OS LICENCE NO. CYAL50447168

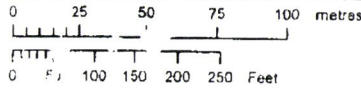

OUTPUT SCALE: 1:2,500

CAPTURE RESOLUTION:
The map objects are only accurate to the
resolution at which they were captured.
Output scale is not indicative of data capture scale.
Further information is available at
<http://www.osi.ie>; search 'Capture Resolution'





Comhairle Contae Chill Mhantáin Wicklow County Council

**Pleanáil, Forbairt Eacnamaíochta agus Tuaithe
Planning, Economic and Rural Development**

Áras An Chontae / County Buildings
Cill Mhantáin / Wicklow
Guthán / Tel. (0404) 20148
Faics / Fax (0404) 69462
Rphost / Email. plandev@wicklowcoco.ie
Suíomh / Website www.wicklow.ie

**Alphaplan Design
Suite 14, Block 1
Broomhall Business Park
Rathnew
Co. Wicklow**

18th June 2025

RE: Application for Certificate of Exemption under Section 5 of the Planning & Development Acts 2000 (as amended). – EX63/2025

A Chara

In respect of your query under Section 5 of the Planning and Development Act 2000 (as amended), received on 26th May 2025, in order to fully assess the Section 5 query, you are requested to submit further details concerning the proposed development, as follows:

- a) Please confirm the query for which a Section 5 declaration is sought. In this regard, please:
 - confirm number and size of forestry plots to which the query relates;
 - provide details of the nature of the works proposed. Note: the felling licence application form indicates that it is proposed to clear fell 2no. plots and change the use of the lands (deforestation);
- b) Please confirm whether the development is licensed or approved under section 6 of the Forestry Act 2014 (No. 31 of 2014). If a licence has been granted, a copy of same should be submitted.

Mise, le meas

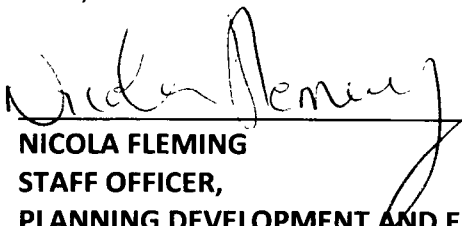
**NICOLA FLEMING
STAFF OFFICER,
PLANNING DEVELOPMENT AND ENVIRONMENT.**



*Tá an t-ábair seo ar fáil i bhformáid dhigiteach.
This document is available in digital format on request.*

Ba chóir gach comhfhreagras a sheoladh chuig an Stiúrthoir Seirbhísí, Pleanáil, Forbairt Eacnamaíochta agus Tuaithe
All correspondence should be addressed to the Director of Services, Planning, Economic and Rural Development





**WICKLOW COUNTY COUNCIL
PLANNING DEPARTMENT**

Section 5 – Application for declaration of Exemption Certificate

TO: Fergal Keogh SE
FROM: Suzanne White SEP
REF: EX63/2025
DECISION DUE DATE: 22/06/2025
APPLICANT: LINDA MCGARRY
DEVELOPMENT: TREE FELLING
LOCATION: BALLYCULLEN, ASHFORD, CO. WICKLOW

Planning History

Application site: none identified

Landholding:

21/1391 - dwelling, waste water treatment system to EPA Standards, stables unit, entrance and associated works. Application withdrawn following recommendation of refusal in respect of housing need and visual impact/design.

Section 5's

None identified on iPlan.

Unauthorised development

None identified

Question

The query set out on the application form is:

“felling licence granted by Dept of Agriculture and they have now requested the owner to seek a section 5 declaration”

Development plan:

Wicklow County Development Plan 2022-2028

Landscape category:

North East Mountain Lowlands AHA

Watercourse:

None in proximity

Protected structures / archaeology:

None recorded in proximity

Protected views and prospects:

None in proximity

Legislative Context

Planning and Development Act, 2000 (as amended):

Section 3 (1):

“development” means—

- (a) the carrying out of any works in, on, over or under land, or the making of any material change in the use of any land or structures situated on land, or
- (b) development within the meaning of Part XXI (inserted by section 171 of the Maritime Area Planning Act 2021).]

“exempted development” has the meaning specified in section 4;

“use”, in relation to land, does not include the use of the land by the carrying out of any works thereon;

“works” includes any act or operation of construction, excavation, demolition, extension, alteration, repair or renewal and, in relation to a protected structure or proposed protected structure, includes any act or operation involving the application or removal of plaster, paint, wallpaper, tiles or other material to or from the surfaces of the interior or exterior of a structure.

Section 4 sets out the types of works that while considered ‘development’, can be considered ‘exempted development’ for the purposes of the Act.

Section 4 (1) (i)

“development consisting of the thinning, felling or replanting of trees, forests or woodlands or works ancillary to that development, but not including the replacement of broadleaf high forest by conifer species”

Section 4(2) makes provision for ministerial regulations to set out further exemptions. The 2001 Planning Regulations as amended derive from this section and designate further works as being exempted development for the purposes of the act.

Section 4 (4) Notwithstanding *paragraphs (a), (i), (ia) and (l) of subsection (1)* and any regulations under *subsection (2)*, development shall not be exempted development if an environmental impact assessment or an appropriate assessment of the development is required.

Planning and Development Regulations 2001 (as amended)

Article 8F of the Planning and Development Regulations 2001 (as amended), provides that *‘Development (other than the replacement of broadleaf high forest by conifer species) that is licensed or approved under section 6 of the Forestry Act 2014 (No. 31 of 2014) and that consists of – (a) the thinning, felling or replanting of trees, forests or woodlands, or (b) works ancillary thereto, shall be exempted development’*.

Forestry Act 2014

“forest” means land under trees with—

- (a) a minimum area of 0.1 hectare, and
- (b) tree crown cover of more than 20 per cent of the total area, or the potential to achieve this cover at maturity, and includes all species of trees;

“deforestation” means the conversion of a forest into land that is not a forest;

Assessment

The submitted site location plan indicates 2no. plots of lands outlined in red, whereas the felling licence application form and plan indicates 3no. plots. The Section 5 application form states that a felling licence has been granted by the Department of Agriculture. The felling licence has not been submitted and there is no record of same on the Dept. of Agriculture’s ‘forestry licence viewer’. Only a felling licence application form has been submitted, which it is noted is not completed. The total area of the lands as stated on the felling licence application form is 2.8ha. Of this, it is proposed to clear fell 2no. land parcels of 0.4ha each and to thin the remaining 2ha. The felling licence form indicates that it is proposed to change the use of the 2no. clear fell plots to commercial use.

It is considered that the query for which a declaration is requested is not clear. It is not clear whether the section 5 declaration relates to 2 or 3 forestry plots, relates to change of use of the lands and whether a felling licence has been granted. Further information is required.

Recommendation: FURTHER INFORMATION

1. In order to fully assess the Section 5 query, you are requested to submit further details concerning the proposed development, as follows:

- a) Please confirm the query for which a Section 5 declaration is sought. In this regard, please:
 - confirm number and size of forestry plots to which the query relates;
 - provide details of the nature of the works proposed. Note: the felling licence application form indicates that it is proposed to clear fell 2no. plots and change the use of the lands (deforestation);
- b) Please confirm whether the development is licensed or approved under section 6 of the Forestry Act 2014 (No. 31 of 2014). If a licence has been granted, a copy of same should be submitted.



Suzanne White SEP
17/06/2025



Comhairle Contae Chill Mhantáin Wicklow County Council

**Pleanáil, Forbairt Eacnamaíochta agus Tuaithe
Planning, Economic and Rural Development**

Áras An Chontae / County Buildings
Cill Mhantáin / Wicklow
Guthán / Tel (0404) 20148
Faics / Fax (0404) 69462
Rphost / Email plandev@wicklowcoco.ie
Suíomh / Website www.wicklow.ie

MEMORANDUM

WICKLOW COUNTY COUNCIL

**TO: Suzanne White
Senior Executive Planner**

**FROM: Nicola Fleming
Staff Officer**

**RE:- Application for Certificate of Exemption under Section 5 of the
Planning and Development Acts 2000 (as amended).
EX63/2025**

I enclose herewith application for Section 5 Declaration received completed on 26/05/2025.

The due date on this declaration is 22nd June 2025.

**Staff Officer
Planning, Economic & Rural Development**





Comhairle Contae Chill Mhantáin Wicklow County Council

**Pleanáil, Forbairt Eacnamaíochta agus Tuaithe
Planning, Economic and Rural Development**

Áras An Chontae / County Buildings
Cill Mhantáin / Wicklow
Guthán / Tel: (0404) 20148
Faics / Fax: (0404) 69462
Rphost / Email: plandev@wicklowcoco.ie
Suíomh / Website: www.wicklow.ie

**Alphaplan Design
Suite14 , Block 1
Broomhall Business Park
Rathnew
Co. Wicklow**

27th May 2025

RE: Application for Certificate of Exemption under Section 5 of the Planning and Development Acts 2000 (as amended). – EX63/2025 for Linda McGarry

A Chara

I wish to acknowledge receipt on 26/05/2025 full details supplied by you in respect of the above Section 5 application. A decision is due in respect of this application by 22/06/2025.

Mise, le meas



**Nicola Fleming
Staff Officer**

Planning, Economic & Rural Development



Wicklow County Council
County Buildings
Wicklow
0404-20100

27/05/2025 10:54.36

Receipt No : L1/0/345934

E COPELAND
BROOMHALL
RATHNEW
CO WICKLOW

PLANNING SUBMISSIONS	80.00
GOODS	80.00
VAT Exempt/Non-vatable	

Total : 80.00 EUR

Tendered :
Credit Card 80.00
EX63/2025

Change : 0.00

Issued By : Joanne Tighe
From : Customer Service Hub
Vat reg No 0015233H

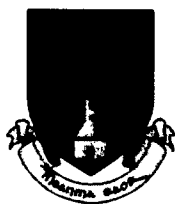

Wicklow County Council
County Buildings
Wicklow
Co Wicklow
Telephone 0404 20148
Fax 0404 69462

Office Use Only

Date Received _____

Fee Received _____

RECEIVED 26 MAY 2023

**APPLICATION FORM FOR A
DECLARATION IN ACCORDANCE WITH SECTION 5 OF THE PLANNING &
DEVELOPMENT ACTS 2000 (AS AMENDED) AS TO WHAT IS OR IS NOT
DEVELOPMENT OR IS OR IS NOT EXEMPTED DEVELOPMENT**

1. Applicant Details

- (a) Name of applicant: LINDA M'GARRY
Address of applicant: BALLINASTOE GOLF CLUB
ROUNDWOOD G WICKLOW

Note Phone number and email to be filled in on separate page.

2. Agents Details (Where Applicable)

- (b) Name of Agent (where applicable) ALPHAPLAN DESIGN
Suite 14 Block 1, Broomhall Business Park
Rathnew, Co Wicklow
Address of Agent : Tel 086 2461269 & 0404 64123
Email eugene@alphaplansdesign.com
Website: www.alphaplansdesign.com

Note Phone number and email to be filled in on separate page.

3. Declaration Details

i. Location of Development subject of Declaration BALLYCULLEN
ASHFORD GULLKROW

ii. Are you the owner and/or occupier of these lands at the location under i. above?
Yes/ ~~No~~

iii. If 'No' to ii above, please supply the Name and Address of the Owner, and or occupier
/

iv. Section 5 of the Planning and Development Act provides that : If any question arises as to what, in any particular case, is or is not development and is or is not exempted development, within the meaning of this act, any person may, on payment of the prescribed fee, request in writing from the relevant planning authority a declaration on that question. You should therefore set out the query for which you seek the Section 5 Declaration
FELLING LICENCE GRANTED BY DEPT OF
AGRICULTURE AND THEY HAVE NOW
REQUESTED THE OWNER TO SEEK A
SECTION 5 DECLARATION.

Additional details may be submitted by way of separate submission.

v. Indication of the Sections of the Planning and Development Act or Planning Regulations you consider relevant to the Declaration
PART 3

Additional details may be submitted by way of separate submission.

vi. Does the Declaration relate to a Protected Structure or is it within the curtilage of a Protected Structure (or proposed protected structure) ? NO

vii. List of Plans, Drawings submitted with this Declaration Application _____
SITE LOCATION MAPS @ 1:10500 & 1:2500
COPY OF FELLING LICENCE
AERIAL PHOTOGRAPH OF AREAS TO BE FELLED

viii. Fee of € 80 Attached ? YES.

Signed : Egon Gohl Dated : 26 MAY 2015

Additional Notes :

As a guide the minimum information requirements for the most common types of referrals under Section 5 are listed below :

A. Extension to dwelling - Class 1 Part 1 of Schedule 2

- Site Location Map
- Floor area of structure in question - whether proposed or existing.
- Floor area of all relevant structures e.g. previous extensions.
- Floor plans and elevations of relevant structures.
- Site Layout Plan showing distance to boundaries, rear garden area, adjoining dwellings/structures etc.

B. Land Reclamation -

The provisions of Article 8 of the Planning and Development Regulations 2001 (as amended) now applies to land reclamation, other than works to wetlands which are still governed by Schedule 2, Part 3, Class 11. Note in addition to confirmation of exemption status under the Planning and Development Act 2000(as amended) there is a certification process with respect to land reclamation works as set out under the European Communities (Environmental Impact Assessment) (Agriculture) Regulations 2011 S.I. 456 of 2011. You should therefore seek advice from the Department of

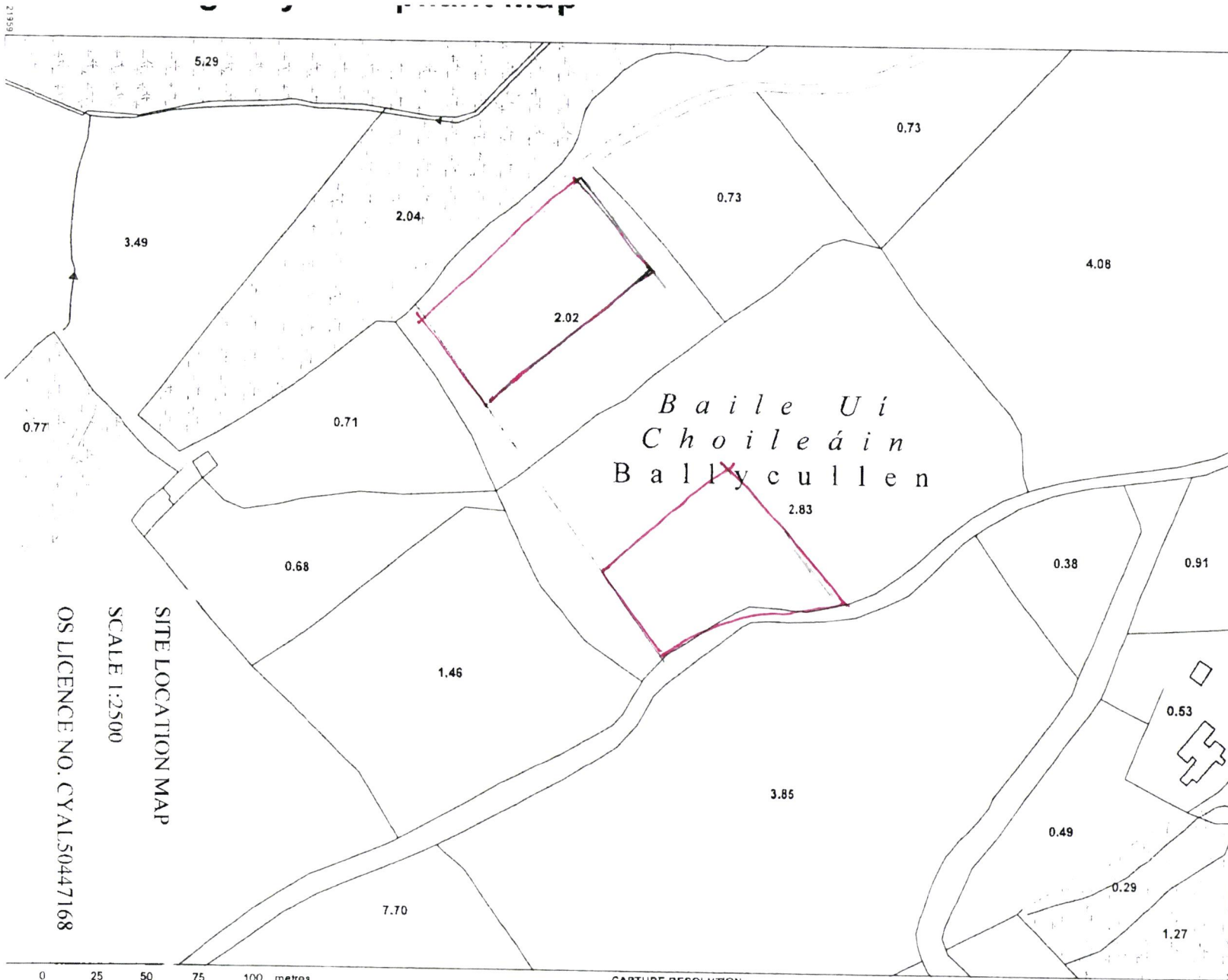

CENTRE COORDINATES:
ITM 722251,696592

PUBLISHED: 16/11/2021
ORDER NO.: 50233481_1

MAP SERIES: 1:5,000
MAP SHEETS: 3961

COMPILED AND PUBLISHED BY:
Ordnance Survey Ireland,
Phoenix Park,
Dublin 8,
Ireland.

Unauthorised reproduction
infringes Ordnance Survey Ireland
and Government of Ireland
copyright.

All rights reserved.
No part of this publication may
be copied, reproduced
or transmitted in any form
or by any means without the prior
written permission of
the copyright owners.

The representation on this map
of a road, track or footpath
is not evidence of the existence
of a right of way.

Ordnance Survey maps
never show legal property
boundaries, nor do they
show ownership of
physical features.

© Suirbhéireacht Ordanáis Éireann,
2021
© Ordnance Survey Ireland, 2021
www.osi.ie/copyright

LEGEND:
<http://www.osi.ie>,
search 'Large Scale Legend'

SITE LOCATION MAP
SCALE 1:2500
OS LICENCE NO. CYAL50447168

OUTPUT SCALE: 1:2,500

CAPTURE RESOLUTION:
The map objects are only accurate to the
resolution at which they were captured.
Output scale is not indicative of data capture scale.
Further information is available at
<http://www.osi.ie>; search 'Capture Resolution'

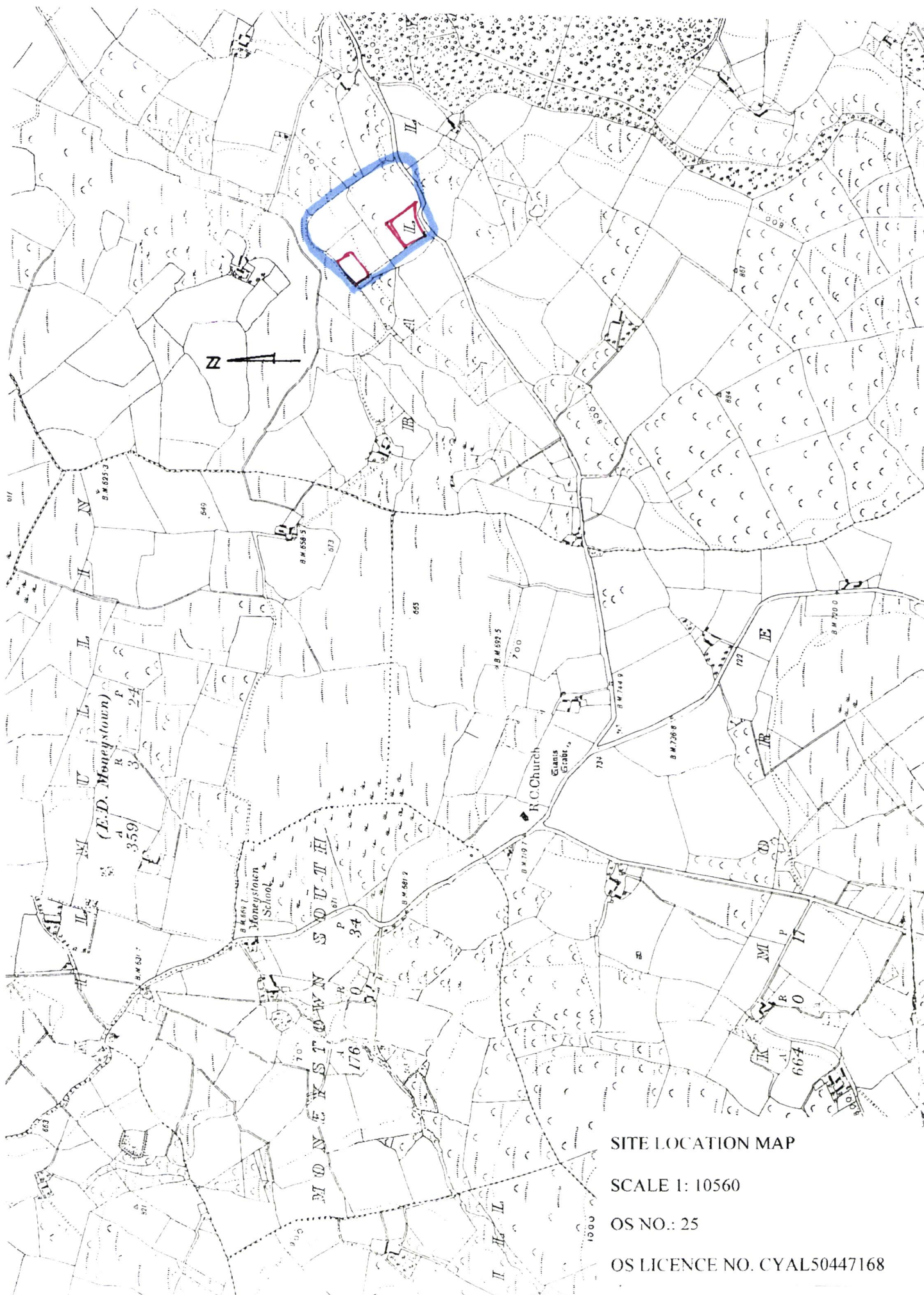

SITE LOCATION MAP

SCALE 1: 10560

OS NO.: 25

OS LICENCE NO. CYAL50447168



Application for a Licence to Fell Trees (please refer to Guidance Notes)

Please note Felling licence applications can be made online through a registered forester

Part 1 – Applicant who will be the licensee (please refer to Guidance Notes)

The Applicant can be the Owner(s), Lessee(s) or Occupier(s) of the land or an Agent of the Owner, Lessee or Occupier. (Please complete either part 1a or 1b, as appropriate).

Where there is more than one applicant (licensee), e.g. multiple owners, details of the person or legal entity to which the licence should be sent should be entered in part 1a or 1b below. Form *Felling Application 2* should be used to submit details of each additional applicant. It must be submitted together with this application.

1a Individual	Surname:	Mc Garry	First Name(s):	Linda
	Address:	Ballinastoe, Roundwood, Co. Wicklow		
	Please enter your Felling Licence Applicant (FLO Number):			

1a Legal Entity	Legal Entity Name:	(e.g. company, partnership, trust.)		
	Address:			
	Eircode:	Telephone:	Email:	
	CRO Number:	Felling Licence Applicant (FLO Number):		

Land ownership status: Freehold ☐ Leasehold ☐ Occupier for the time being ☐

See page 6 for further required information that will not be displayed in the Forestry Licence Viewer.

Part 2 – Agent Details (See guidance notes) only complete where an agent prepares the application on behalf of the applicant – the agent must not declare himself or herself to be the applicant/licensee.

Surname:	Kenna	First Name(s):	Tom
Legal Entity Name:	Roundwood Timber Ltd	CRO Number:	(for company)
Address: *	Moneystown, Roundwood, Co. Wicklow		(for company)
Eircode: *	A98 W832	Telephone: *	087 2692444
FLR Number:		Email: *	Tom.Kenna@roundwoodtimber.com
		Felling Licence Agent Number:	AGT 121260

* See guidance notes.

See page 6 for further required information that will not be displayed in the Forestry Licence Viewer.

Location of trees:

Townland	Electoral Division	County
Ballycullen	Ballycullen	Wicklow

[illegible]

³Where the harvest type is Single Trees or Line of Trees, the estimated volume of all trees to be felled must be stated for each species. For all other harvest types (such as thinning or clear fell), an accurate estimate of the volume per hectare to be felled for each species must be stated on the application form.

See Part 5 if the proposal is not to replant any or all plots after felling or to afforest at an alternative site.

[illegible]

¹The areas proposed for replanting in the above table should match exactly the plots described in Part 3.

²The actual no. of trees to be replanted is only required where the Harvest Type is Single Trees or Line of Trees.

Part 5 – Conversion from forest to another land-use (not applicable to a thinning application)

Where the intention is to remove the trees and not replant the area felled, please specify the land-use that you propose to create:

Enhancing Annex habitats and species



Supporting Renewable Energy and Energy Security



Commercial Development



Other (please specify) _____

Applicants are generally required to afforest alternative land of good quality and equivalent size to the area that is to be felled. (Please refer to Guidance Notes for further information).

It should be noted that where grant-aided forestry currently in receipt of premium payments is the subject of this application, **any grants and premiums that were paid by the Forest Service in respect of the areas to be felled may require repayment.**

Where it is proposed not to replant any or all the plots felled but instead to plant an alternative site, please complete Part 5a below. (It is accepted that in some instances the alternative site may not yet have been acquired, therefore not all the details requested may be available. In such cases, provide all the details available and a brief explanation of the situation in the space provided at "Any Other Details (e.g. Commitment to purchase an Alternative Site)" below.)

5a Proposed Alternative Planting Site

Address of Alternative Planting Site(s)	Forest Service Pre-Planting Approval Number	Name and Address of Owner of Alternative Planting Site	Any Other Details (e.g. Commitment to purchase an Alternative Site)
Barneemnogh Co. Leitrim	CN87542	Coillte Teo	



Part 6 – Planning Permissions (where applicable)

If the land where the trees are located is the subject of a Planning Permission Application or has had Planning Permission granted, please supply the following information:

Planning Authority:

Planning Register Number:

An Bord Pleanála Case Reference number (where applicable):

Development Description:

Current status of Planning Permission Application:

Part 7 –Declaration

- I understand that, in applying for a tree felling licence, if I furnish information or make a statement that I know to be false or misleading in a material respect, I shall be guilty of an offence.
- I hereby apply for a felling licence as set out in this application.
- I consent to the release of non-personal information supplied by me in respect of this application in order that the Department of Agriculture, Food and the Marine may comply with current environmental consultation and Freedom of Information Act requirements.
- I/We understand that once our application is accepted by the Department, my/our application information, that will include my/our name(s) and address(es) and the location of the land, the nature of the operation, etc. to which the application refers, will be made publicly available on the Forestry Licence Viewer (FLV). The FLV is an online portal that displays information relating to forestry licence applications, to assist with public participation in the decision-making process on planning applications. Forestry licence applications will be available to the public for inspection, via the FLV.
- If an agent has completed the application form on your behalf and you would like the agent to receive a copy of the licence, that may issue, please tick the following box ☒

Signature of the applicant* (person applying to be the licensee, as specified in Part 1)

Tom Kenna

Date:

* If the signatory is not the owner:

1. In what capacity is the signatory making the application (e.g. agent, forester, farm manager, son, daughter, etc. or position in the Company if the licensee is to be a company)?

Forester

2. The owner must sign the following authorisation to allow the applicant to apply for a licence in the applicant's name:

Owners Signature (s):

Date

Owner's Name(s):

(BLOCK CAPITALS)

Under no circumstances should any felling operations commence until the Department has issued a Licence.



Required information that will not be displayed in the Forestry Licence Viewer
Part 1 – information in relation to the applicant.

1a Individual

Eircode: A98 FY91 Telephone: 087 6714908 Email: linda@littleexplores.ie

If the applicant does not have a Felling Licence Applicant (FLO Number), please enter one of the following to facilitate registration on the Felling Licence Database: Herd No: _____ or

FO No: _____ and DOB: 5/2/76
or PPSN: 691763G

1b Legal Entity

If the applicant does not have a Felling Licence Applicant (FLO Number), please enter one of the following to facilitate registration on the Felling Licence Database:

Herd No: _____ or FO No: _____

Required information that will not be displayed in the Forestry Licence Viewer
Part 2 – information in relation to the agent.

If you do not have Felling Licence Agent Number, please enter either of the following to register the above-named agent on the Felling Licence Database: Herd No: _____ or FO No: _____

Or PPSN: 2505639L and DOB: 28/03/96 (where the agent is an individual)

Required information that will not be displayed in the Forestry Licence Viewer
Part 3 – information in relation to landownership.

If the land is registered with the Property Registration Authority, please provide the folio number(s). If the land is unregistered, please provide proof of ownership with the application.

Registered: ☐

Unregistered: ☐

Folio(s): _____

MAP INFORMATION REQUIRED

Each application should be accompanied by maps that clearly identify the location of the trees to be felled. At least two maps must be supplied, which must be signed and dated by the landowner or agent:

1. Site Location Map

A map showing the location of the trees in relation to the wider area or district, including an access road. An example of the type of map required is the 1:50,000 Ordnance Survey Map product.

2. Tree Location Map

A map outlining the specific area on which the trees to be felled stand. An example of the type of map required is an Ordnance Survey 1:5,000 series raster map, or a recent colour aerial photograph. Any map supplied must give clear detail; otherwise delays may be experienced as the map may need to be returned.

The individual trees or forest areas to be felled should be clearly delineated on the Tree Location Map and numbered according to the Plot No. information supplied in Part 3 and 4 of the application. The felling areas (Part 3) and replanting areas (Part 4) should have the same boundaries on the ground as delineated on the map.

Please refer to the Forest Service website for examples of completed application forms and maps.

CHECKLIST

- Parts 1 to 7 are fully completed.
- Parts 1, 2 and 3 on page 7 are fully completed.
- Declaration is signed and dated.
- The application is accompanied by the fee of €20. Please note we do not accept cash. Payment may be made via cheque, bank draft, or postal order. Card payments may be made over the phone by calling 053-9163425.
- Where the landowner is nominating a third party to act on their behalf, make sure the landowner has signed Part 7.
- Where land is unregistered, provide proof of ownership.
- Two maps are supplied clearly delineating the individual trees or the area of trees to be felled.
- The maps are signed, dated and annotated correctly.
- For those sites with a non-standard reforestation objective (other than 1.CHF or 2.BHF or 3.MHF), the Department requires a management plan. The management plan included with your application should describe the planned operations as shown in the Guidance Notes, which can be found on the

CONTACT DETAILS

Completed applications forms and maps should be posted to:

Felling Section
Forestry Division
Department of Agriculture, Food and the Marine
Johnstown Castle
Co. Wexford
Y35 PN52

Tel: 053 91 63425/63400

Email: felling.forests@agriculture.gov.ie

Please note Felling licence applications can be made online through a registered forester

DATA PRIVACY

For full details of Forestry Division's Privacy Notice in relation to the Forestry Licence Viewer, please see [link].